

## Safety relief valves, weight-loaded

### 32010

#### Description

Safety relief valves are used in the beverage and food processing industries, as well as in the chemical-pharmaceutical industry.

Safety relief valves:

- protection of pressurized systems against overpressure
- subject to the Pressure Equipment Directive 2014/68/EU
- may be used for the intended purpose only
- fulfil the requirements of AD 2000/ A2 and DIN EN ISO 4126-1

CE 0062



#### Valve types

Type	Fluids	Lifting manual	Lifting pneumatic	Seals EPDM / FKM	Proximity switch	Heating cartridge
32010	F/G/D	x	X	X / ⊗	⊗	⊗

Liquids (F), Air/Gases (G), Steam (D)

⊗ optional

#### Valve data

Type	Safety relief valve
Type of functioning	Opens with pressure/closes with weight force
Order code	32010

#### Product range

Materials	Stainless steel 1.4307
Seals	EPDM, optional FKM/FPM ( FDA proof)
Surface	≤ 0.8 µm

#### Other parts

Materials	Stainless steel 1.4301, 1.4307
Seals	EPDM
Surface	precision-turned, matte

#### Production / CIP

Application	Free exit
Fluids (nontoxic)	Fluids/gases/steam (Group II, PED 2014/68/EU) Readily commercially-available CIP cleaning media with 2-4 % caustic/acid
Performance data	Performance data within 10 % pressure increase
Operating pressure	PS min/max 0/10 bar-g
Temperature	TS min/max -20/160 °C
Control air pressure	5 - 7 bar, compressed air connection Ø 6/4 mm

# Safety relief valves, weight-loaded

## 32010

### Valve construction

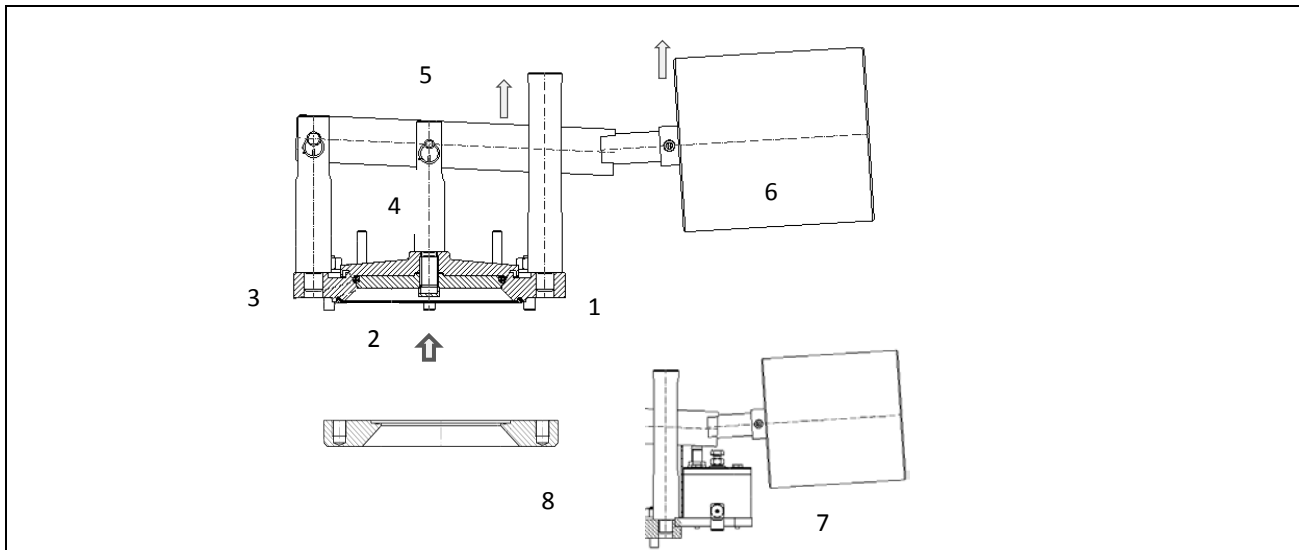
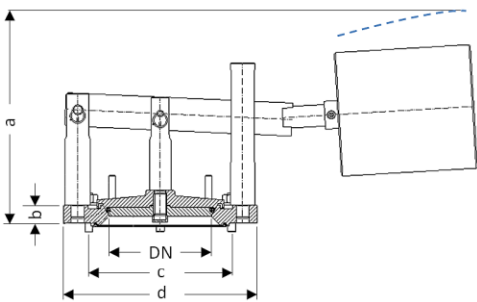
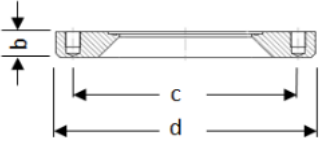

Fig. 1: Type 32010

- |   |                               |   |                    |
|---|-------------------------------|---|--------------------|
| 1 | housing flange                | 5 | lever              |
| 2 | valve inlet [E] – supply pipe | 6 | weight             |
| 3 | valve cone                    | 7 | pneumatic cylinder |
| 4 | valve rod                     | 8 | welding flange     |

### Dimensions

AH-SV-32010	DN	a [mm]	b [mm]	c [Ø]	d [Ø]	pressure [bar]	weight [kg]
	65	270	18.0	170	196	0,5 - 5,0	30 - 60
	80	270	18.0	170	196	0,5 - 5,0	
	100	270	21.5	200	235	0,5 - 3,5	
	125	270	21.5	200	235	0,5 - 3,0	
	65	---	20	170	196	---	3 - 4
	80	---	20	170	196	---	
	100	---	20	200	235	---	
	125	---	20	200	235	---	

## Safety relief valves, weight-loaded

### 32010

#### Performance data

Fluid: water				
32010				
pressure [bar-g]	throughput [kg/h]			
	DN 65	DN 80	DN 100	DN 125
0,5	33.795	49.297	68.140	87.947
1	47.794	69.717	96.365	124.375
2	67.591	98.595	136.281	175.893
3	82.782	120.754	166.909	215.424
3,5	89.414	130.429	180.282	----
4	95.588	139.434	----	----
5	106.871	155.892	----	----

Fluid: air				
32010				
pressure [bar-g]	throughput [Nm <sup>3</sup> /h]			
	DN 65	DN 80	DN 100	DN 125
0,5	815	1.235	1.754	2.330
1	1.102	1.670	2.372	3.150
2	1.676	2.539	3.606	4.789
3	2.250	3.408	4.841	6.429
3,5	2.537	3.843	5.458	----
4	2.824	4.277	----	----
5	3.398	5.147	----	----